

Wi-Fi Vibration



* please read user manual carefully before use this product.

Product Specifications

Input voltage: DC 3V LR03

Static current: $\leq 95 \mu\text{A}$ (average)

Alarm current: $\leq 125 \text{ mA}$

Low voltage notification: $\leq 2.4\text{V}$

Wi-Fi standard: 802.11b/g/n

Vibration levels: High, Medium, Low

Operating temperature: -10°C to 50°C

Operating humidity: Up to 95% RH

Instructions for Use

1. Slide the mounting bracket upward and outward to remove it, then install the batteries.



2. Insert two batteries into the battery compartment according to the polarity markings. Once the batteries are installed, the indicator light will remain on briefly and then turn off.

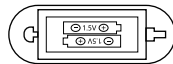

3. Download the "Smart Life" app from major app stores or scan the QR code provided below.



Android/iOS

4. Register and log in to the app using your mobile number → press and hold the reset button for more than 5 seconds until indicator light blinking → In the app, go to the "My Home" page, click the "+" or "Add Device" to add the devices → Select "Sensor," then choose "Vibration Sensor" → Enter the Wi-Fi password (Wi-Fi network only 2.4GHz, not 5GHz) → Click the indicator flashing quickly → The device will connect to the network automatically.

5. If your phone's Bluetooth is enabled, follow the steps shown in the app to connect.

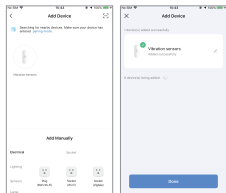

6. If Bluetooth connecting fails, switch to manual connecting, while device in flashing quickly mode,

press and hold the reset button for 5 seconds again until the indicator light flashes slowly (flashes once every 1.5 seconds) → In the App, Click the indicator flashing slowly then click "Go to Connect." → Choose the SmartLife_XXXX network and return to the app to continue adding the device.

7. Once the device connect to App successfully, click the vibration sensor icon in the app to enter the interface. Before installing the sensor, tap the product three times.

If the indicator light briefly stays on, it indicates that vibration has been detected and an alert will appear in the app. (After the alert, the device will back to normal status automatically after 30 seconds)

